



# NETWORK TERMINATION DEVICE WITH VOICE (NTD+V)

NDD-0315

The NetComm **FTTdp Network Termination Device with Voice (NTD+V) NDD-0315** is a unique all-in-one solution, designed to power a **Distribution Point Unit (DPU)** in FTTdp deployments and deliver an enhanced Internet experience thanks to an integrated Gfast modem supporting gigabit broadband services and voice port for connection of a telephone handset. Fault and performance monitoring ensure the quality of service, making it easier to identify and fix problems.



## REVERSE POWERING THE DPU

The **NDD-0315** provides power to the DPU directly from the customer premises over the copper lead-in cable, simplifying and reducing the cost of FTTdp deployments since the DPU does not require connection to a local power source.

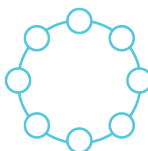

## ALL-IN-ONE SOLUTION FOR A BETTER EXPERIENCE

The **NDD-0315** features the latest technology to achieve Gigabit service speeds with the integrated **Gfast** modem. The device minimises interoperability challenges and ensures the best user experience without interruptions.



## SIMPLE INSTALLATION

Simply labeled ports and cables, together with an explanatory Quick Start Guide, make self-installation quick and easy for end users, eliminating the need for a technician to visit.

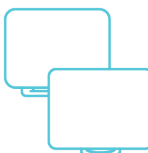

## COMPATIBLE WITH EXISTING GATEWAY DEVICES

The **NDD-0315** provides an Ethernet connection allowing a subscriber to continue using a pre-existing gateway device, if present. It also enables operators to use their existing Ethernet-enabled gateway devices as deployed for other access technologies.



## PLUG AND PLAY

Once the **NDD-0315** is connected and turned on, the high-speed service is automatically activated, providing a quick and cost-efficient roll-out.



# CONNECTION DIAGRAM

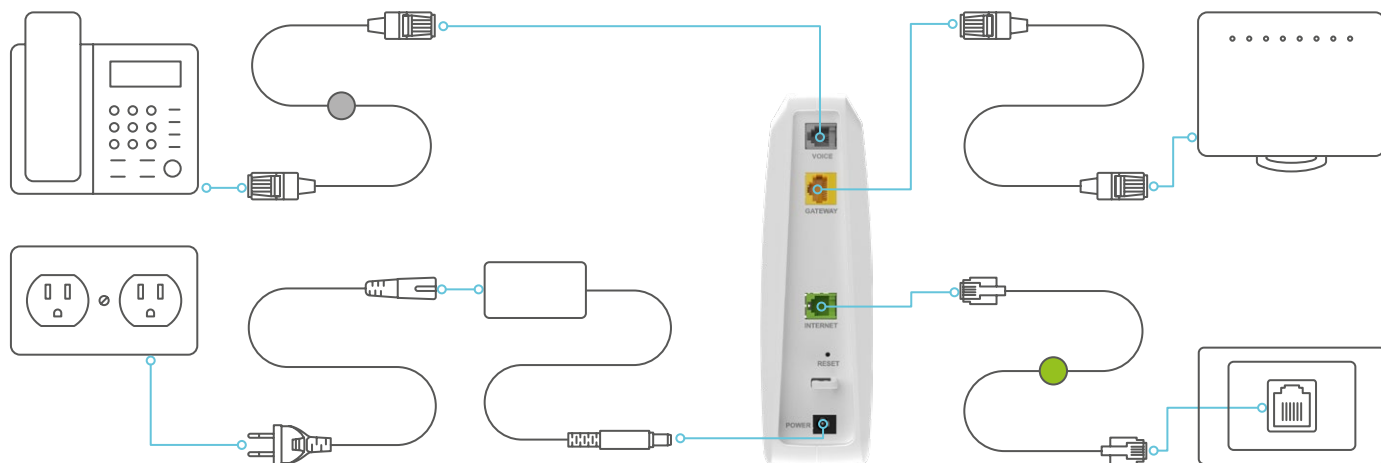

## DEPLOYMENT SCENARIOS:

- › FTTH deployments requiring a fiber-extension solution free from the need to connect local AC power at the DPU.
- › FTTdp deployments with tight roll-out schedules and budgets, demanding an easy to install all-in-one solution that eliminates the need to visit customer premises and cuts installation costs.



# TECHNICAL SPECIFICATIONS

## DSL PROTOCOLS

- › ITU G.9700 and G.9701, including Amendments 1,2,3 - G.fast supporting profiles 106a/b and 212a

## INTERFACES

- › 1 x RJ45 Gigabit Ethernet port
- › 1 x RJ11 DSL port
- › 1 x RJ11 Telephone port
- › 1 x Power input port (DC Jack)
- › 1 x Recessed reset button
- › 1 x LED Indicator toggle button

## LED INDICATORS

- › Power
- › RPF link
- › DSL
- › LAN
- › Phone

## SECURITY

- › Meets general security requirements including:
  - › Isolation of management plane from user data plane
  - › Management traffic encryption
  - › Supports digitally signed and verified firmware downloads

## SUPPORTED CODECS

- › G.711, G.711  $\mu$ -law, G.711 A-law
- › G.722, G.722.2
- › G.729
- › G.168

## REMOTE MANAGEMENT

- › Automatically managed by the DPU
- › Optional BBF TR-069 CPE WAN Management Protocol – Issue 1, Amendment 5
- › BBF TR-181 Device Data Model for TR-069 - Issue 2, Amendment 11
- › Layer-2 fault and performance monitoring based on 802.1ag and Y.1731

## ETHERNET SUPPORT

- › QoS-aware queueing and scheduling

## SAFETY STANDARDS

- › IEC 62368-1
- › UL 62368-1
- › ITU-T.K21

## EMC STANDARDS

- › FCC EMC Part 15, Class B
- › ICES-003 Class B

## REGULATORY COMPLIANCE

- › FCC
- › CA Prop 65

## POWER SUPPLY

- › **Input:** AC 90 – 264V / 47–63Hz

## REVERSE POWERING

- › ETSI TS 101 548 v2.2.1, Class SR2
- › **Output:** DC 60V/250mA

## DIMENSIONS & WEIGHT

- › 182mm (L) x 157mm (W) x 59mm (H)
- › 0.4 kg

## ENVIRONMENTAL

- › **Operating temperature range:** 0°C to 45°C
- › **Storage temperature range:** -20°C to +70°C
- › **Relative humidity:** 5–95%, non-condensing

## KEY FEATURES

- › Installed in customer premises
- › Powers the FTTdp DPU avoiding power supply installation and connection at the distribution point
- › Gfast 212MHz support
- › High-speed Gigabit Ethernet port for connection to a computer, wireless router or gateway device

- › RJ11 Voice port for telephone connection
- › Provides super-fast speeds in a mixed access technology network
- › Labelled ports and cables, and a Quick Start Guide enabling easy installation by the end user
- › LED indicators provide Power,

- Reverse power feed, DSL link, LAN and Voice status information
- › Management traffic encryption
- › Supports digitally signed and verified firmware downloads

NetComm NDD-0315 Spec Sheet Rev 8

Trademarks and registered trademarks are the property of NetComm Wireless Pty Ltd or their respective owners. Specifications are subject to change without notice. Images shown may vary slightly from the actual product.



**NETCOMM**  
HEAD OFFICE | SYDNEY  
18-20 Orion Road Lane Cove NSW 2066  
Sydney | Australia | +61 2 9424 2070  
[www.netcomm.com](http://www.netcomm.com)



**ZHONE**  
HEAD OFFICE | USA  
5700 Tennyson Pkwy  
Suite 400, Plano, TX 75024  
Texas | USA | +1 877-946-6320  
[www.zhone.com](http://www.zhone.com)



**NetComm**  
a division of **zhone**